

REMOVAL AND INSTALLATION

Heater Hose — 5.4L and 6.8L

Removal and Installation

All vehicles

1. Drain the cooling system. For additional information, refer to Section 303-03.
2. Remove the nuts and position the vapor management valve (VMV) and bracket aside.

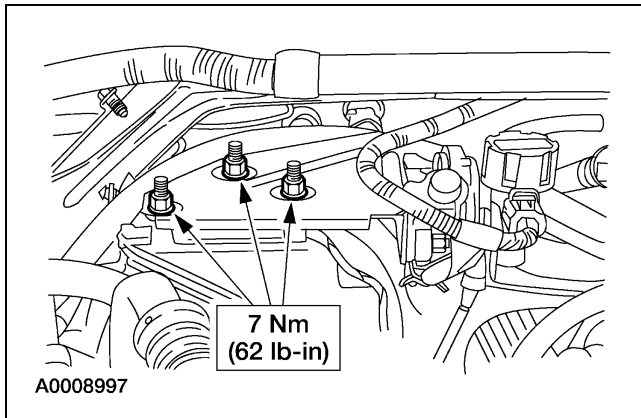

3. Release the clamp and disconnect the heater inlet hose (18472) from the engine.

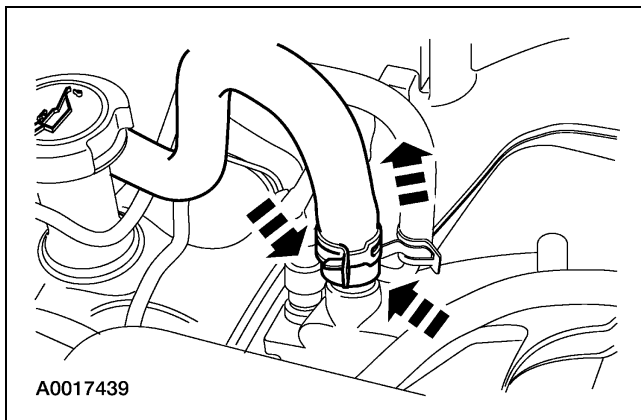

4. Release the clamp and disconnect the heater hose from the engine.

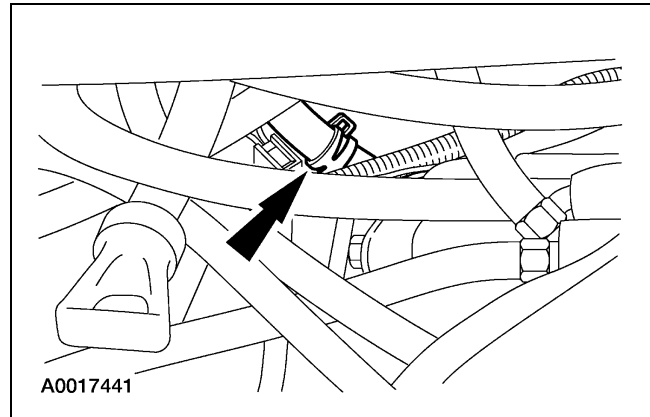

5. **NOTE:** Auxiliary climate control heater control valve is shown, non-auxiliary heater control valve is similar.

Remove the heater control valve.

- 1 Disconnect the vacuum line.
- 2 Release the clamps and disconnect the heater hoses.
- 3 Remove the heater control valve.

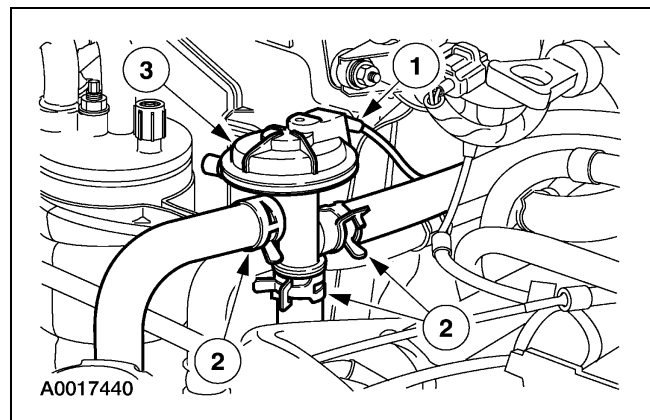

REMOVAL AND INSTALLATION (Continued)**Vehicles equipped with auxiliary climate control**

- Release the clamp and disconnect the heater hose from the heater outlet hose.

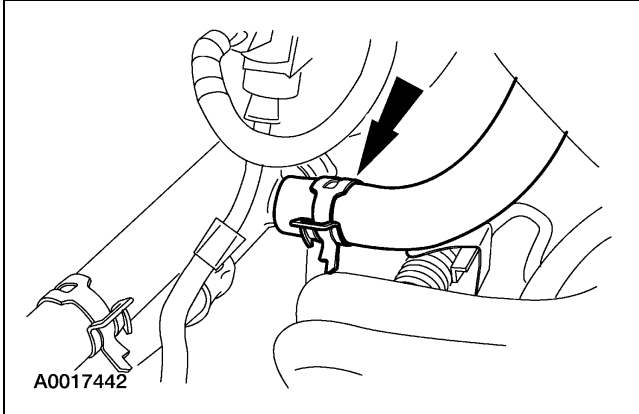

- Disconnect the heater hose couplings from the underbody auxiliary heater lines.

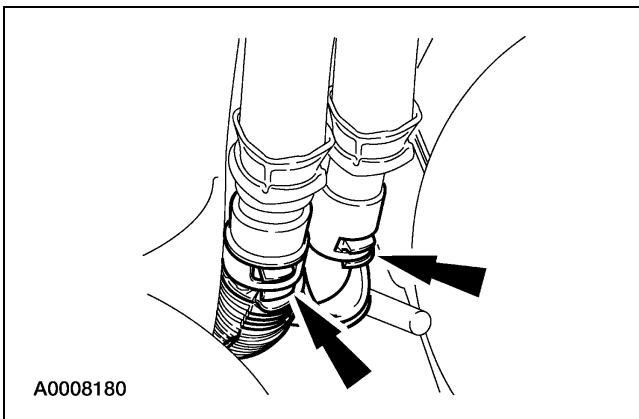
**All vehicles**

- Disconnect the heater inlet and outlet hose couplings from the heater core.

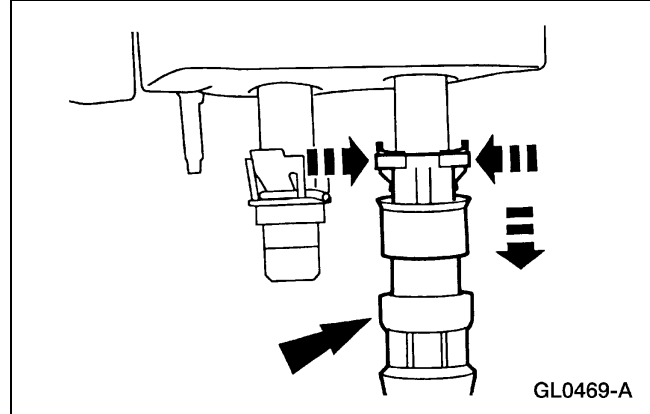

- To install, reverse the removal procedure.
 - Clean and lubricate the coolant hoses with plain water only if needed.
- Fill the engine cooling system. For additional information, refer to Section 303-03.