

GRASPING HAND

—
Benoît Durandin
4 rue du point de vue
92310 Sevres / France

—
Siret:
417 789 682 00057

—
www.graspinghand.com
order@graspinghand.com



TECHNICAL DATA SHEETS + PRICES

—
FOR SWEETBOX AND SCORPI

GRASPING HAND

— Benoît Durandin
4 rue du point de vue
92310 Sevres / France

— Siret:
417 789 682 00057

— www.graspinghand.com
order@graspinghand.com



— **Grilamid®**
EMS

— Models marked as TR 90 have their frame made of Grilamid.

Grilamid is a very light, flexible and resistant polyamide, which exceeds the classic polycarbonate or nylon in its qualities and in a fundamental way influences safety and resistance of the whole product.

SWEETBOX / TECHNICAL DATA SHEET

— Nylon protective case for the Raspberry Pi.

Sweetbox is the smallest Rpi case that you can find, It's sturdy Nylon material keep it away from dust, shock and scratches, extending the lifetime of the board.

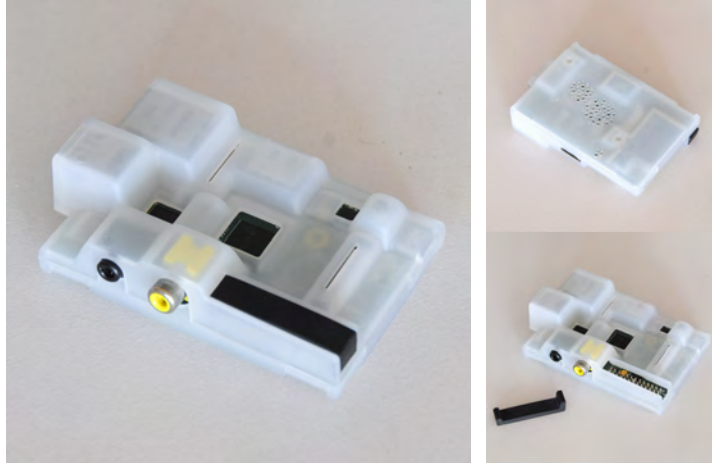

The Sweetbox comes pre-assembled, with its flexible GPIO cap.

FEATURES

- - Fitting Model B Rev 1 and 2
- Raspberry Pi Camera Compatible
- PiO Micro-SD Adapter Compatible
- Removable rubber cap to access to the GPIO pins
- Slots to access to the CSI and DSI ports
- Ventilation holes under the case and above the heating sources
- Mounting holes on the bottom part of the case in order to fix it on a flat surface.

MATERIAL

— Translucent white nylon / Injection of a mix of 2 material from EMS-GRIVORY , 80% L20G and 20% Grilamid TR90.

GPIO CAP

— Removable cap made of extruded black rubber

DIMENSIONS (mm)

— 95mm x 65mm x 25 mm

WEIGHT

— 35 g

PACKAGING

— Zip bag with instructions

CODE HS

— 392690

GRASPING HAND

—
Benoît Durandin
4 rue du point de vue
92310 Sevres / France

—
Siret:
417 789 682 00057

—
www.graspinghand.com
order@graspinghand.com



HEATSINKS / TECHNICAL DATA SHEET

—
Aluminum heatsinks for Raspberry Pi computer, anodized in mate black, sold separately or with the Sweetbox.

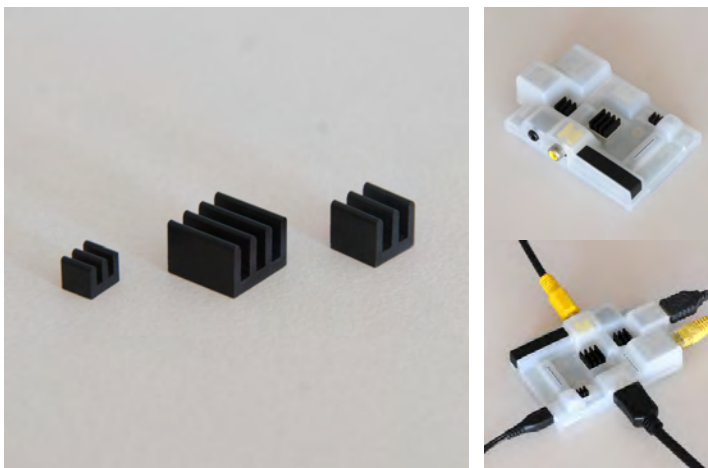

Each heatsink is designed by Graspinghand and CNC machined especially for this project.

The set come with three ready-to-mount thermal pads (3M 8815)

The set has been originally designed to fit perfectly into the Sweetbox case, but are working great with or without a case. They allow your Raspberry Pi to run around 4°C cooler at full calculation.

MATERIAL

—
Black anodized aluminium

DIMENSIONS (mm)

—
95mm x 65mm x 25 mm

WEIGHT

—
4 g

PACKAGING

—
Zip bag with instructions

CODE HS

—
761699

GRASPING HAND

—
Benoît Durandin
4 rue du point de vue
92310 Sevres / France

—
Siret:
417 789 682 00057

—
www.graspinghand.com
order@graspinghand.com



SCORPI / TECHNICAL DATA SHEET

—
The original high-end flexible mount for the Raspberry Pi Camera.

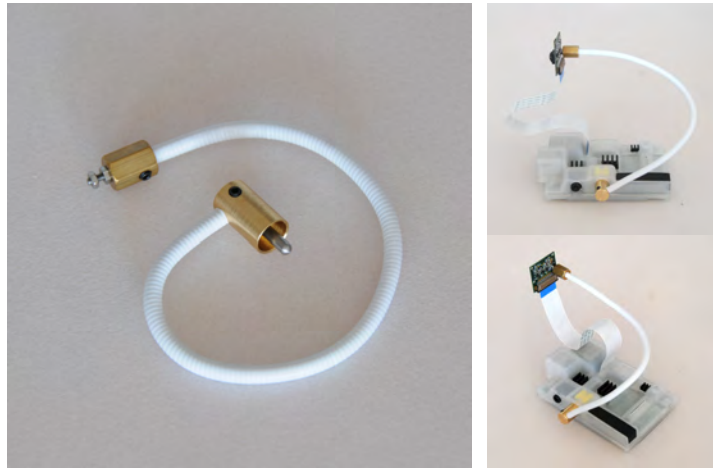

The ScorPi allows you to place the camera above the Raspberry Pi in any position, it plugs directly into the RCA port of your Raspberry Pi, and works with and without a case.

The tube is flexible but stays fixed in the position it's bent into for precise adjustments.

Each connecting part is designed by Graspinghand and CNC machined especially for this project.

The ScorPi comes pre-assembled with a right-angle RCA brass plug on one end, and a 2mm bolt fixing on the other. Simply slide the 2mm bolt fixing through the mounting hole of the camera and bolt using the included stainless steel half nut.

Features

- Plugs Directly into the Raspberry Pi via RCA port
- Comes Complete with 1 x Stainless Steel Nut
- OD 4.0mm Gooseneck Tubing with PVC sleeving

MATERIAL

—
Bronze connectors and stainless steel bolts, metallic gooseneck with white PVC sheath.

Lenght (mm)

—
190 mm

WEIGHT

—
27 g

PACKAGING

—
Zip bag with instructions

CODE HS

—
83

GRASPING HAND

Benoît Durandin
4 rue du point de vue
92310 Sevres / France



Siret:
417 789 682 00057

www.graspinghand.com
order@graspinghand.com

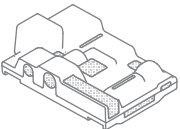
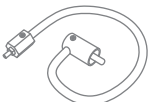
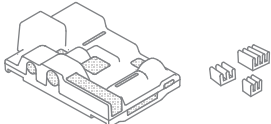
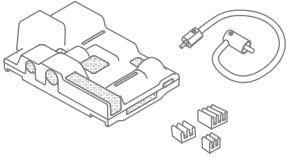

PRICE LIST

- * ALL PRICES ARE BASED IN EUROS / CURRENCY RATES IN THIS LIST ARE APPLIED AS OF NOVEMBER 13 2013
- * ALL INDICATED PRICES ARE CALCULATED WITHOUT SHIPPING COST
- * VAT NOT APPLICABLE, ARTICLE 293 b OF CGI (Code général des Impôts) FRANCE
- * PAYMENTS THROUGH PAYPAL IN EURO CURRENCY

PRODUCT(S)	DESCRIPTION	RECOMMENDED RETAIL PRICE PER UNIT	BULK PRICE PER UNIT	
SWEETBOX		€ 13.95 / £ 11.75 / \$ 18.75	50 - 100 100 - 300 300 - 600 600 +	€ 8.70 / £ 7.33 / \$ 11.69 € 8.15 / £ 6.87 / \$ 10.95 € 7.55 / £ 6.36 / \$ 10.15 € 6.95 / £ 5.86 / \$ 9.34
SCORPI		€ 10.95 / £ 9.23 / \$ 14.71		€ 6.85 / £ 5.77 / \$ 9.20 € 6.40 / £ 5.40 / \$ 8.60 € 5.90 / £ 4.98 / \$ 7.93 € 5.50 / £ 4.64 / \$ 7.39
SWEETBOX + HEATSINKS		€ 19.95 / £ 16.82 / \$ 26.80		€ 12.45 / £ 10.50 / \$ 16.73 € 11.65 / £ 9.82 / \$ 15.65 € 10.80 / £ 9.11 / \$ 14.51 € 10.00 / £ 8.43 / \$ 13.44
SWEETBOX + HEATSINKS + SCORPI		€ 27.95 / £ 23.53 / \$ 37.55		€ 17.45 / £ 14.71 / \$ 23.45 € 16.30 / £ 13.74 / \$ 21.90 € 15.15 / £ 12.77 / \$ 20.36 € 14.00 / £ 11.80 / \$ 18.81
HEATSINKS		€ 7.95 / £ 6.70 / \$ 10.68		€ 4.95 / £ 4.18 / \$ 6.65 € 4.65 / £ 3.92 / \$ 6.25 € 4.30 / £ 3.62 / \$ 5.78 € 4.00 / £ 3.38 / \$ 5.37