

# Android: Motorola (IMAP)

This is a setup guide that will assist you in setting up your Hosted Mailbox on Motorola mobile and tablet devices using IMAP.

1. Locate the "**Settings**" icon within your Apps Drawer.

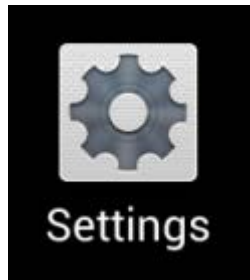

2. Within Settings, scroll down and select "**Add Account**".

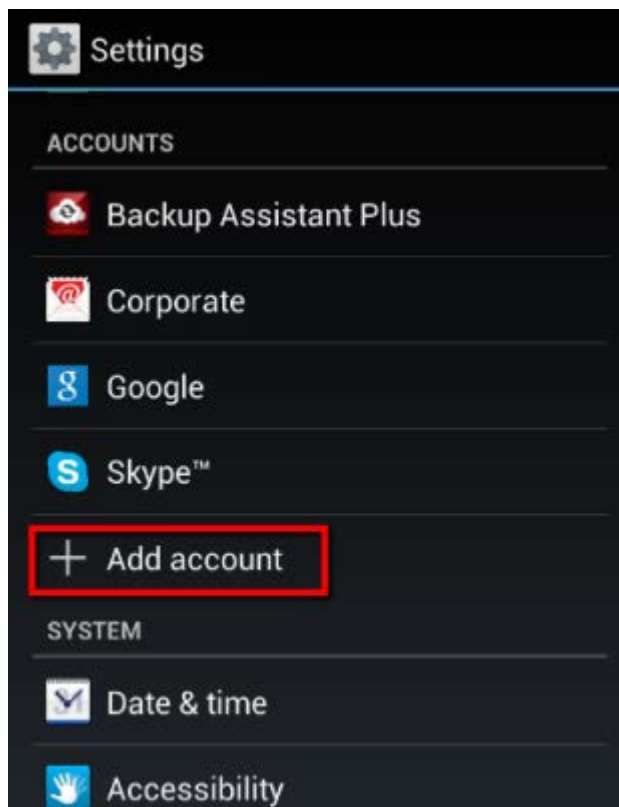

3. Select "**Email**".

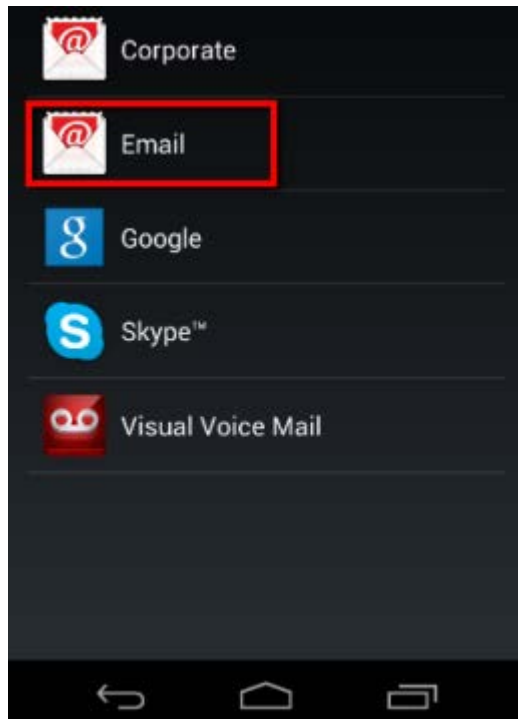

4. Select "**Other**".

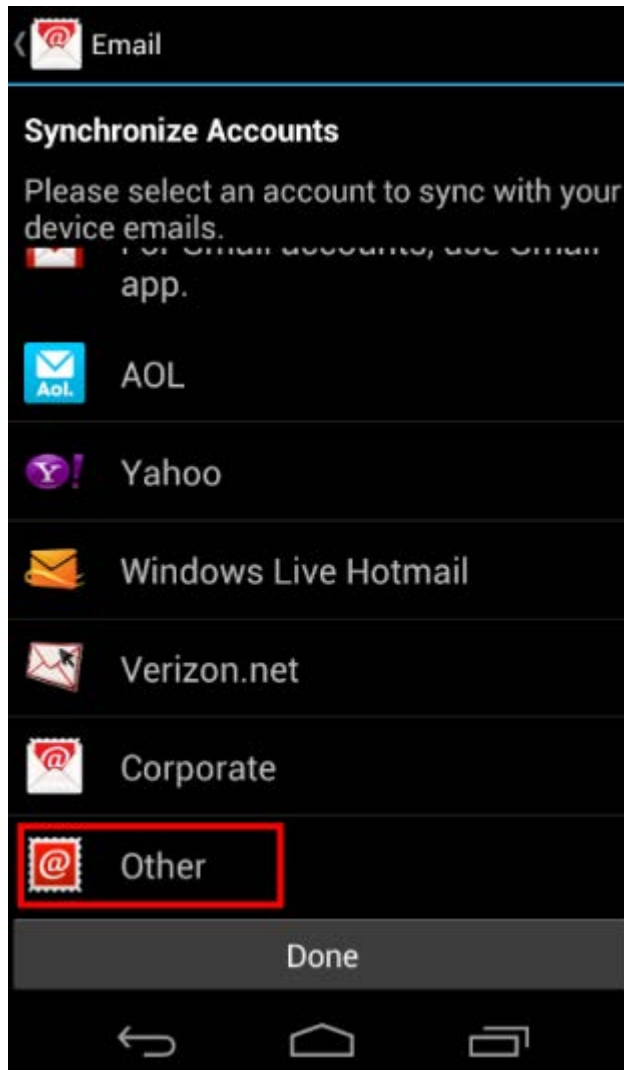

5. Enter the following information:
  - a. "**Email Address**": example@unifyamerica.net
  - b. "**Password**": Your email address password

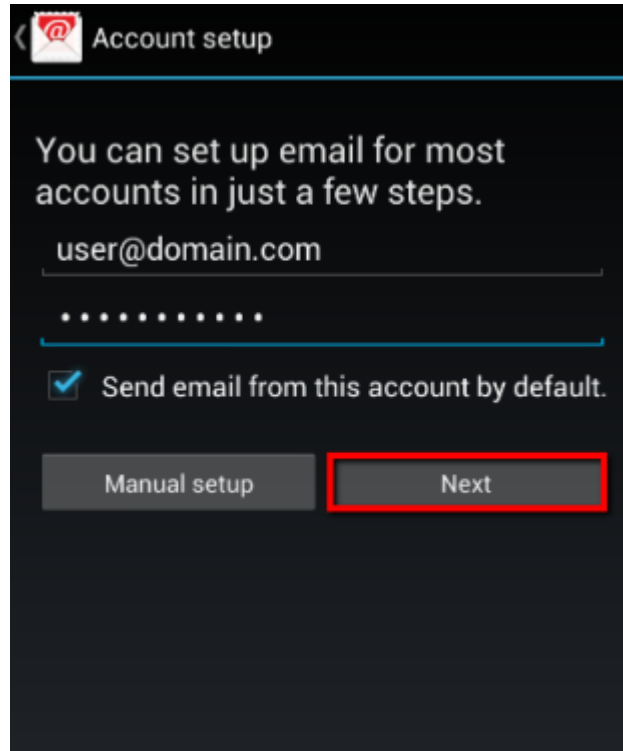

6. Tap "**Next**".
7. Select "**IMAP**" within the Account Setup screen.

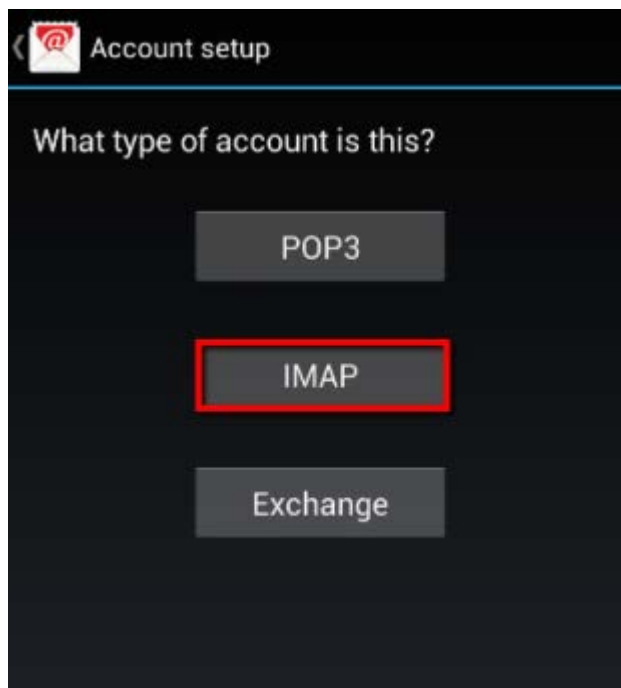

8. Enter the following information:

- a. "**Username**": example@unifyamerica.net
- b. "**Password**": Your email address password
- c. "**IMAP Server**": secure.emailsrvr.com
- d. "**Port**": 993
- e. "**Security type**": SSL
- f. "**Authentication Method**": Auto
- g. "**IMAP path prefix**": Leave this field blank

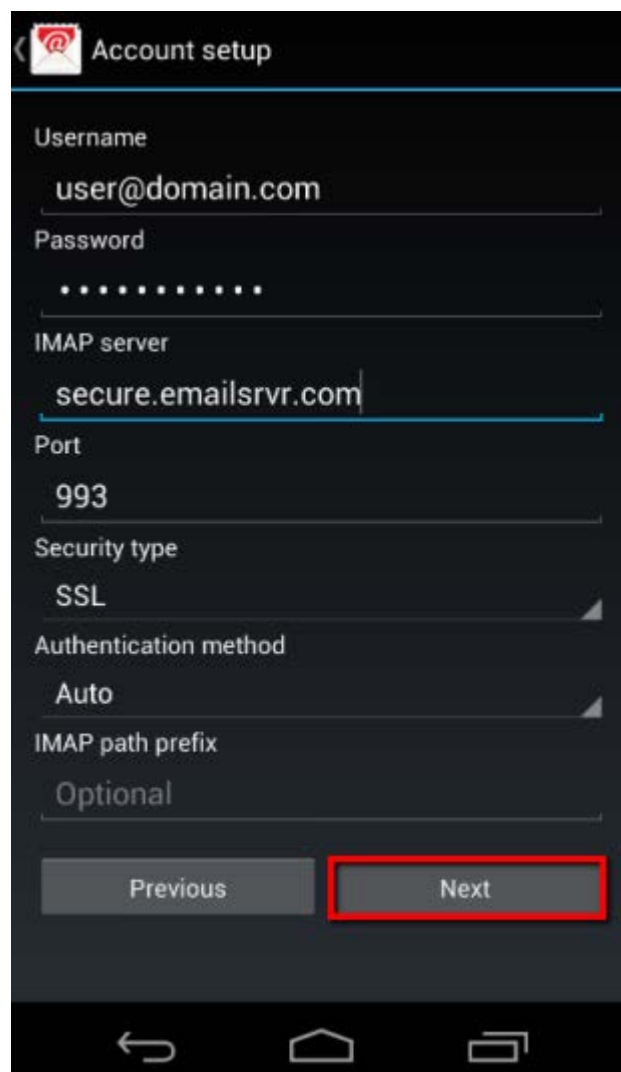

- 9. Tap "**Next**".
- 10. Enter the following information:

- a. **"SMTP server"**: secure.emailsrvr.com
- b. **"Port"**: 465
- c. **"Security type"**: SSL/TLS
- d. **"Require sign-in"**: Checked
- e. **"Authentication method"**: Auto
- f. **"Username"**: example@unifyamerica.net
- g. **"Password"**: Your email address password

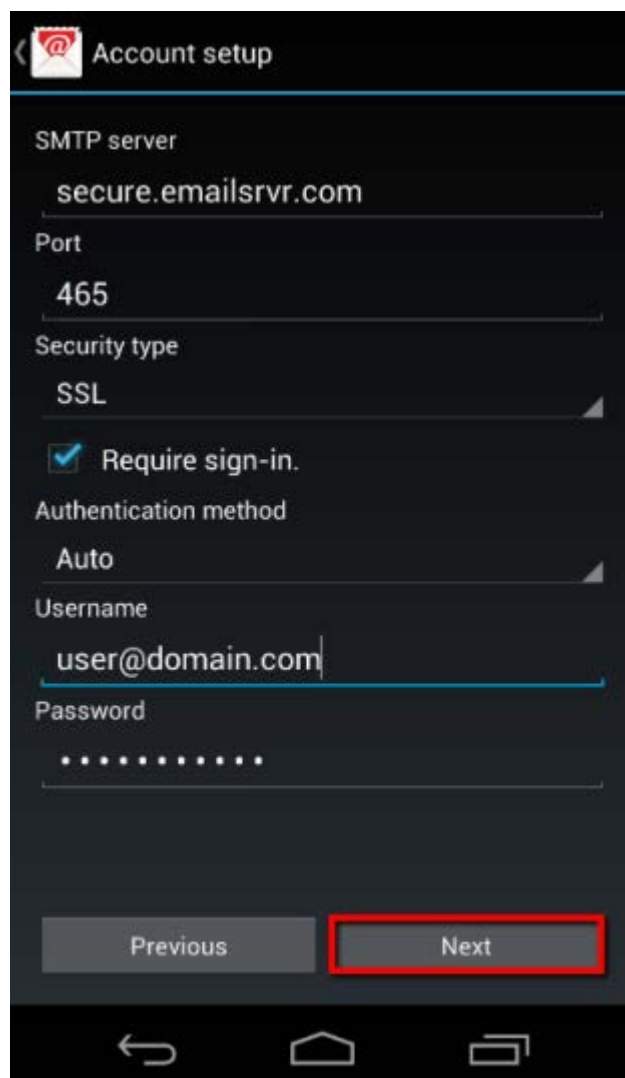

11. Tap **"Next"**.

12. Adjust the displayed mailbox settings, if applicable.

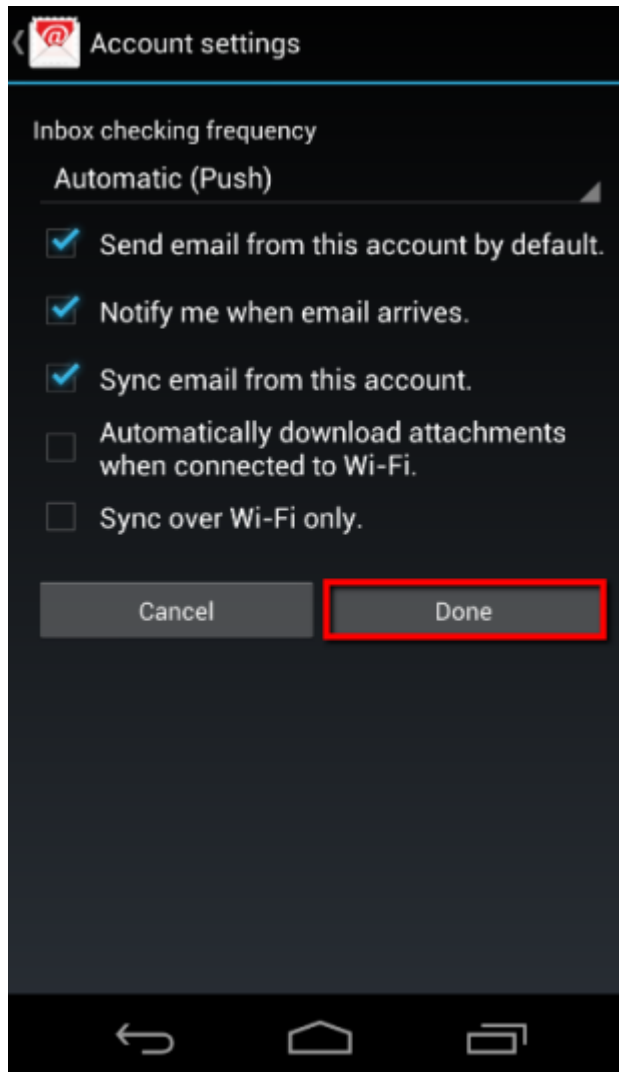

13. Tap "**Done**".

14. Within the "**Account setup**" screen, enter your Email Address and your Name.

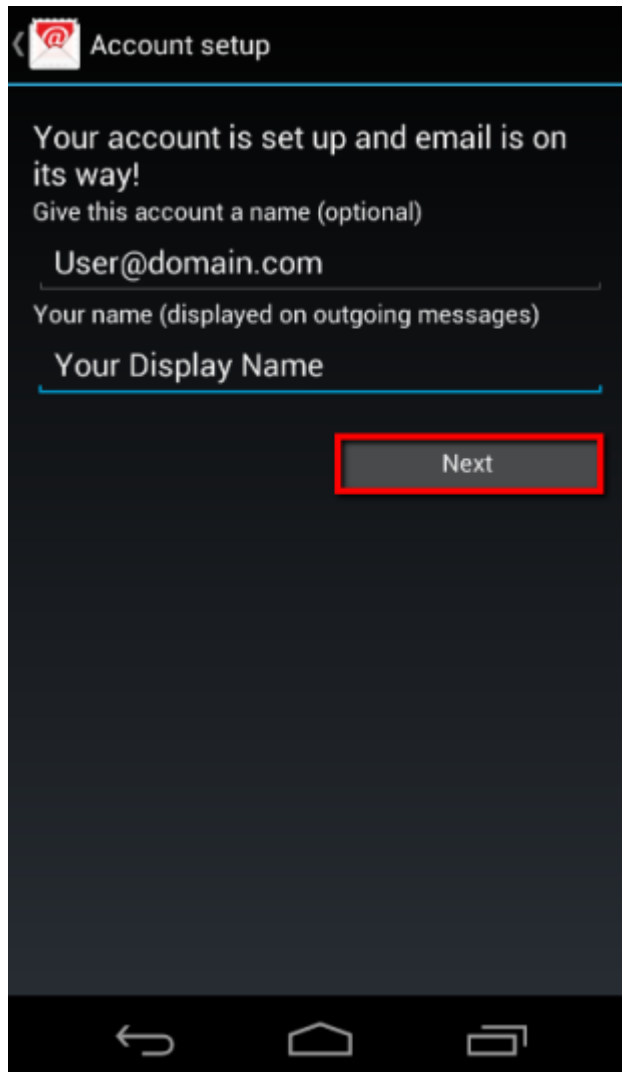

15. Tap "**Next**".

16. Success! Your Motorola device should now begin syncing with your mailbox.