

HOW TO SHARPEN

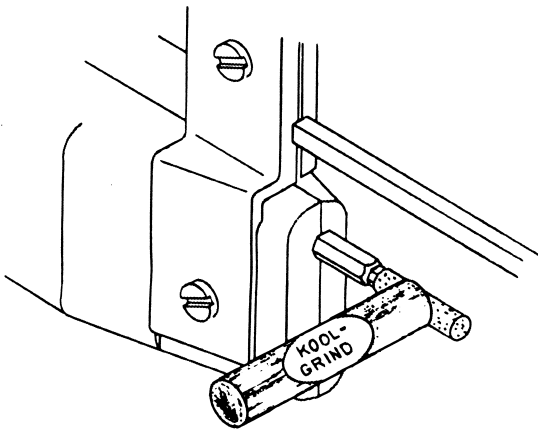

RECOMMENDED FOR COOLER GRINDING USE "KOOL GRIND" LIBERALLY - GENERATES LESS HEAT - WHEEL CLOGGING - EXTENDS WHEEL & CHAIN LIFE. TO USE, TOUCH STICK TO ROTATING WHEEL AFTER EVERY 3 OR 4 CUTTERS SHARPENED.

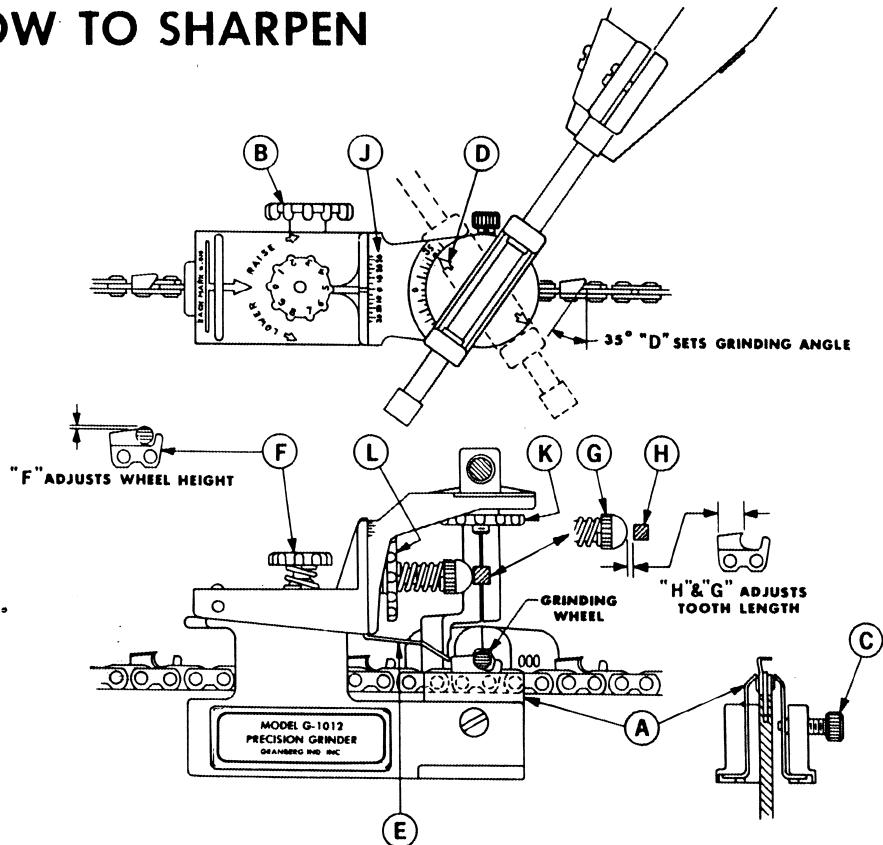

1. PLACE PRECISION GRINDER OVER CHAIN & BAR. TO POSITION PRECISION GRINDER BASE, TIGHTEN SCREW (C) TO LOCK CHAIN CLAMP (A) OVER CHAIN RIVETS AS SHOWN. HOLD PRECISION GRINDER BASE PARALLEL TO BAR, TIGHTEN SCREW (B).
2. BACK OFF SCREW (C) SLIGHTLY TO ALLOW CHAIN TO MOVE THROUGH SNUGLY BUT FREELY (PREVENTS CHAIN FROM TIPPING).
3. POSITION CUTTER BACK AGAINST CHAIN STOP (E). SET ANGLE DIAL (D) TO SELECTED ANGLE (AT 30° OR 35°*) TIGHTEN THUMB NUT (K). SET TILT ANGLE (J) TO SELECTED ANGLE (USUALLY AT 0°*) TIGHTEN THUMB NUT (L).
4. ADJUST HEIGHT DIAL (F) UNTIL GRINDING WHEEL PROTRUDES 1/5 TO 1/10 ABOVE CUTTER*. PRESS SWITCH ON LEFT SIDE OF GRINDER TO START MOTOR. STROKE BACK & FORTH GENTLY (FULL LENGTH OF WHEEL) UNTIL CUTTER IS SHARP.
5. FOR UNIFORM CUTTER LENGTH, HOLD GRINDING WHEEL AGAINST CUTTER. ADJUST CUTTER LENGTH STOP (G) AGAINST STOP BAR (H) THEN BACK OFF ENOUGH TO SHARPEN CUTTER. SHARPEN ALL CUTTERS TO THIS SETTING (LENGTH) AROUND CHAIN THEN RESET ANGLE. (AS BARS VARY IN THICKNESS IT MAY BE NECESSARY TO READJUST (G) WHEN SHARPENING OTHER SIDE OF CHAIN.)

* SEE MANUFACTURERS FILING INSTRUCTIONS.

JOINTING DEPTH GAUGES

DEPTH GAUGE CLEARANCES SHOULD BE CHECKED EVERY 3 TO 4 SHARPENINGS*. THEY CAN BE CHECKED OR LOWERED BY FOLLOWING INSTRUCTIONS BELOW.

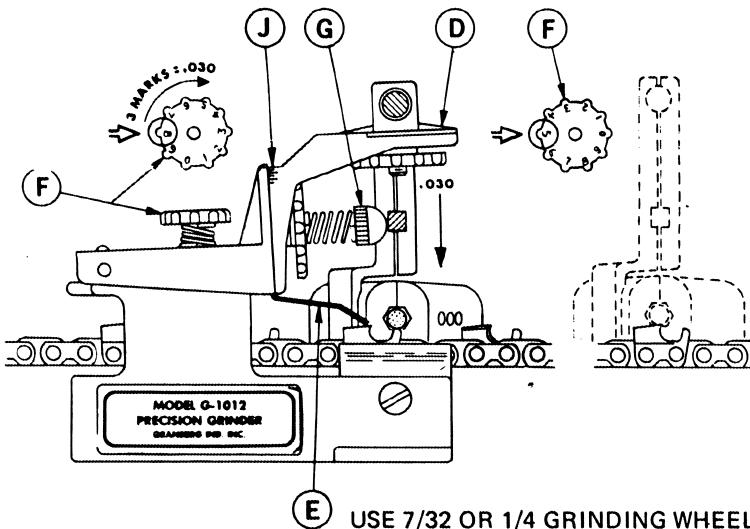

1. INSERT 7/32 OR 1/4 GRINDING WHEEL, SCREW IN FINGER TIGHT. (TO REMOVE USE WRENCHES SUPPLIED WITH CORD ASSY.)
 2. SET TOP DIAL (D) & TILT DIAL (J) TO 0°.
 3. PLACE GRINDING WHEEL ON TOP OF CUTTER TOOTH AS SHOWN.
 4. ADJUST GRINDING WHEEL HEIGHT DIAL (F) SO THAT GRINDING WHEEL JUST TOUCHES TOP OF CUTTER TOOTH. NOTE SETTING ON HEIGHT DIAL (F) THEN BACK OFF FOR CLEARANCE DESIRED* (3 MARKS = .030).
 5. MOVE CUTTER TOOTH BACK UNDER CHAIN STOP (E) UNTIL DEPTH GAUGE IS UNDER GRINDING WHEEL & CHAIN STOP (E) IS ON TOP OF CUTTER AS SHOWN. ADJUST CUTTER LENGTH STOP (G) UNTIL FRAME HANGS APPROXIMATELY VERTICAL.
 6. GRIND ALL DEPTH GAUGES TO THIS SETTING.
- * SEE MANUFACTURERS FILING INSTRUCTIONS.

G1012XT PRECISION GRINDER



ASSEMBLE FRAME TO BASE AS SHOWN

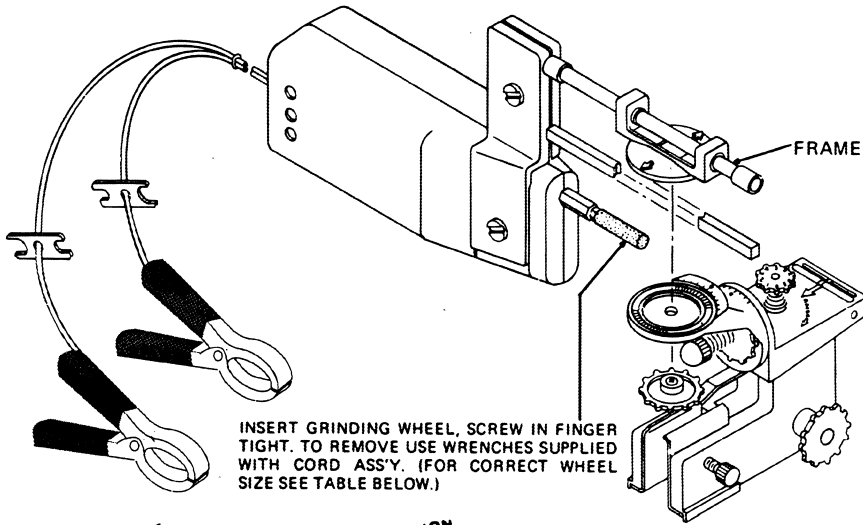

ATTACH ALLIGATOR CLAMPS TO BATTERY. CORRECT (RIGHT) ROTATION. ATTACH RED ALLIGATOR CLAMP TO POSITIVE POLE (+), BLACK ALLIGATOR CLAMP TO NEGATIVE POLE (-). WHEEL MUST TURN TOWARD CUTTER AS SHOWN.



AS CUTTER IS REDUCED IN LENGTH, USE NEXT SMALLER SIZE WHEEL.

USE GRANBERG BLUE GRIT GRINDING STONES FOR MAXIMUM DURABILITY

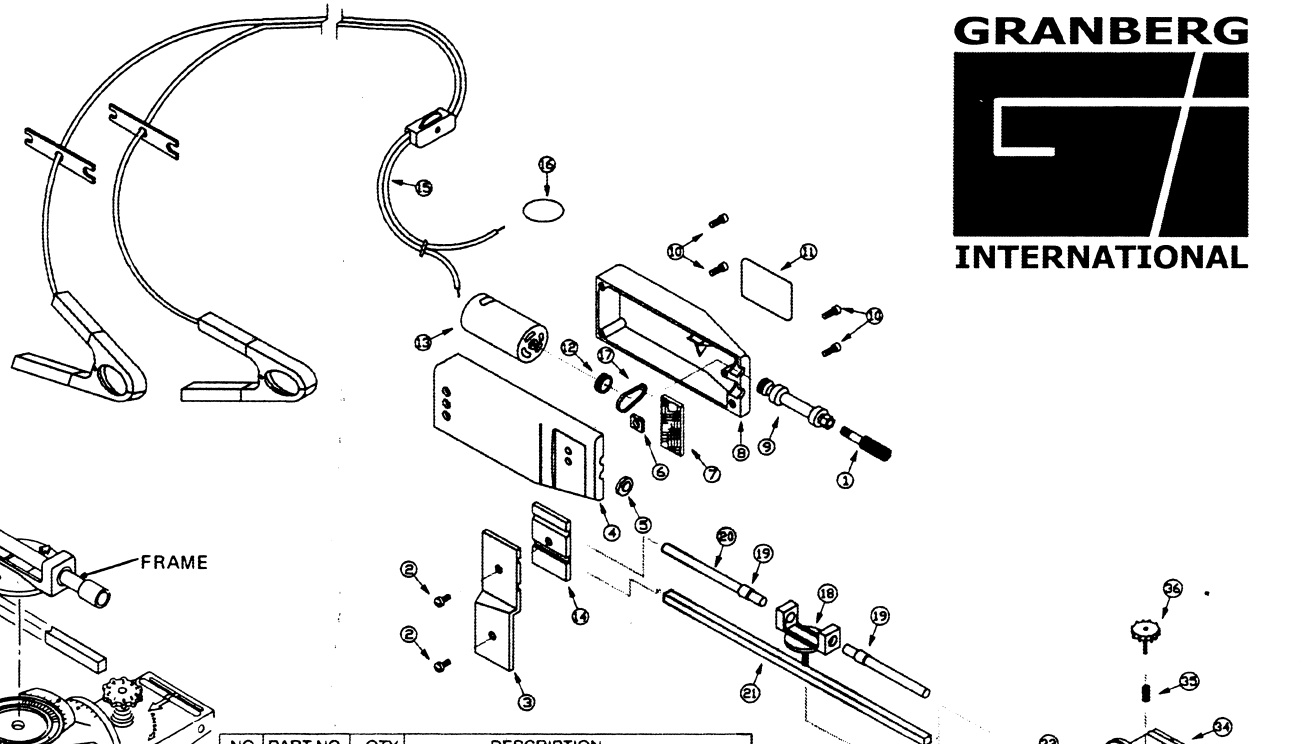

NO	PART NO.	QTY	DESCRIPTION
1	G417	1	5/32"Ø GRINDING STONE
	G418	1	3/16"Ø GRINDING STONE
	G419	1	7/32"Ø GRINDING STONE
2	167F	2	8-32x1/2 PAN HD. SCREW
3	147F	1	MOUNTING BRACKET
4	965F	1	BODY SHELL (LEFT)
5	963F	1	SHELL PLUG
6	294F	1	SQUARE NUT 8-32
7	1044F	1	FILTER
8	964F	1	BODY SHELL (RIGHT)
9	916F	1	MANDREL ASSEMBLY
10	908F	4	SCREW 6x3/8 FIL. HEAD
11	915	1	NAMEPLATE
12	863F	1	DRIVE PULLEY
13	1050F	1	12 VOLT MOTOR
14	146F	1	MOUNTING BRACKET
15	909F	1	CORD ASSEMBLY
16	177L1	1	CAUTION LABEL
17	843F	1	35 TOOTH BELT YELLOW
18	130F	1	SWIVEL GUIDE
19	142F	2	BUSHING
20	140F	1	FILE FRAME SLIDE ROD
21	141F	1	FILE FRAME STOP BAR
22	138F	1	HINGE PIN
23	32F	1	SPRING
24	124F	1	ANCHOR BASE
25	306F	1	THUMB SCREW
26	453F	2	THUMB SCREW
27	135F1B	2	CHAIN CLAMP
28	412F	2	SELF TAPPING SCREW
29	925F	2	THUMB NUT
30	154F	1	TOOTH LENGTH GAUGE
31	137F	1	SPRING
32	136F	1	CHAIN STOP
33	126F	1	TILT & SWIVEL BASE
34	125F	1	ADJUSTMENT BASE
35	145F	1	SPRING
36	134F	1	DEPTH GAUGE

CHAIN PITCH	PART NO.	STONE Ø
1/4 PITCH & .325	G417	5/32"Ø / 4.0MMØ
3/8 LP & 3/8 PITCH*	G418	3/16"Ø / 4.8MMØ
.404 PITCH	G419	7/32"Ø / 5.5MMØ
1/2 PITCH	G420	1/4"Ø / 6.4MMØ

* MAY ALSO USE G419-7/32Ø