

Welcome!

Thank you for purchasing the Edward House from brinca dada. We hope you will enjoy this house as much as we've enjoyed designing it.

Inspired by Neutra's Kaufmann House and Gary Cooper's home designed by A. Quincy Jones, brinca dada's Edward House features many distinguishing architectural features like glass corners, minimalist cut stone and hardwood floors. The Edward House has six rooms including a living room, kitchen, library/office, master bedroom, bathroom and child's bedroom. With its large, open floor plan and floor-to-ceiling windows, the Edward House enjoys year-round sunlight. Finally, the dollhouse is easy on the environment with only eco-friendly woods and non-toxic and lead-free paints.

Enjoy!

Tools you'll need

Screws & Dowels
(Included)



Phillips
Screwdriver



Included Pieces

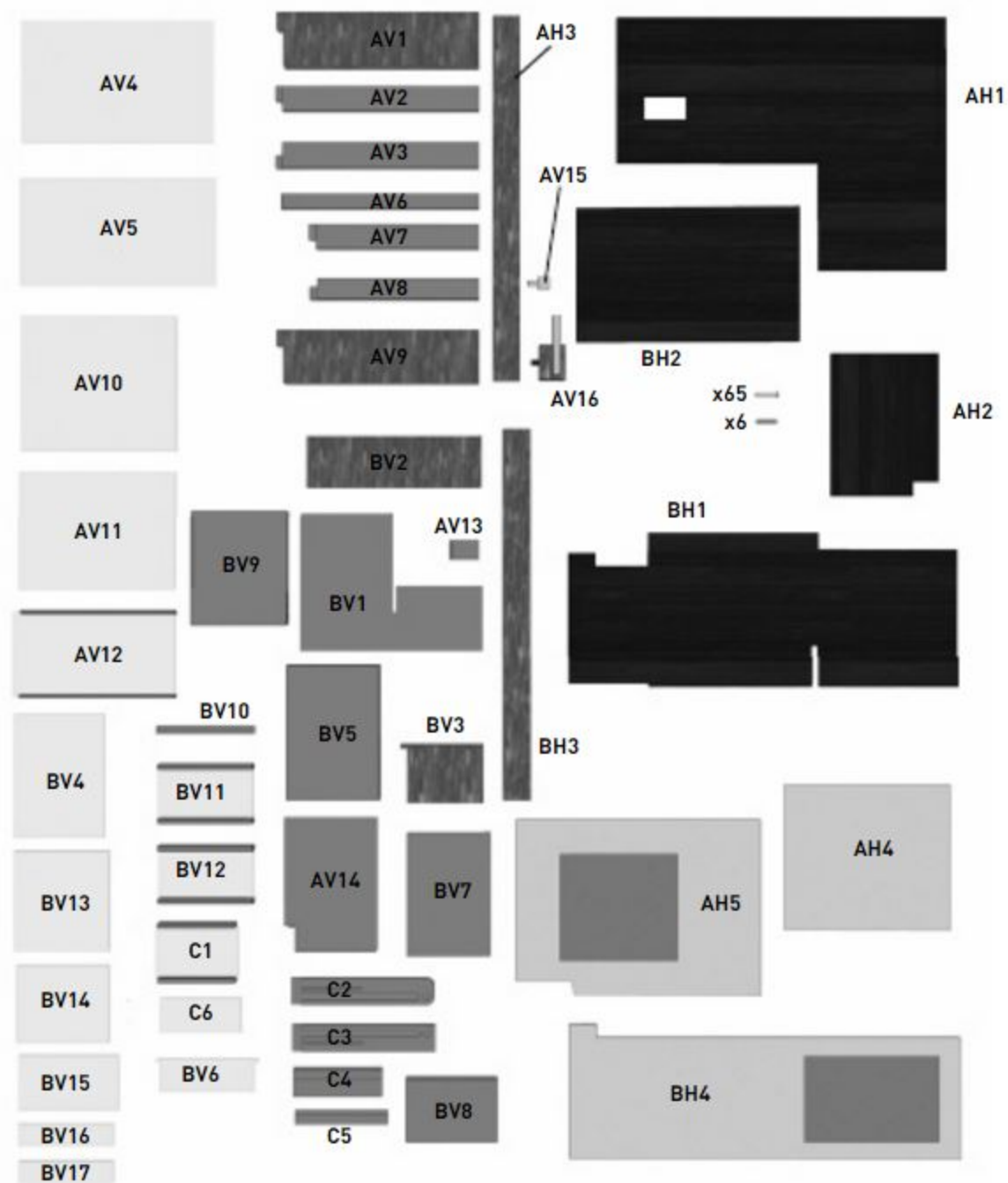

1

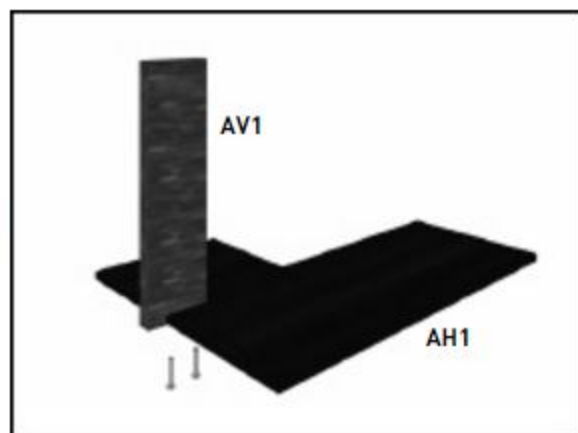
**SIDE A**

Attach AV1 to AH1 using two (2) screws.

2

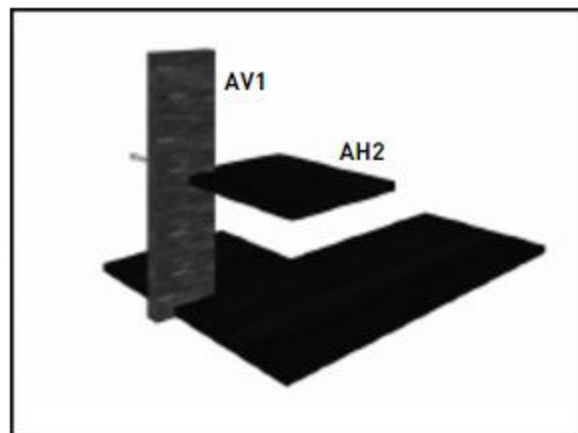

Attach AH2 to AV1 using one (1) screw.

3

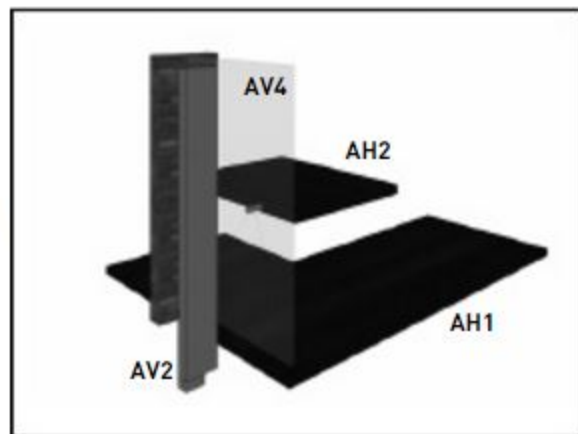

Place AV4 between AH2 and AV2. Attach AV2 to AH2 using one (1) dowel (goes through the hole in AV4). Attach AV2 to AH1 using one (1) screw.

Place AV5 between AH2 and AV3. Attach AV3 to AH2 using one (1) dowel (goes through the hole in AV5).

4

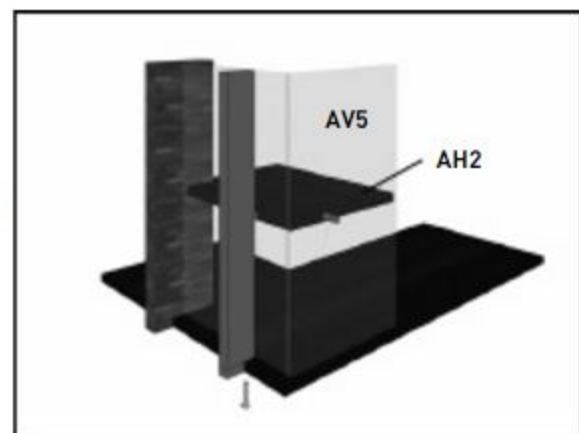

Attach AV3 to AH1 using one (1) screw.

5

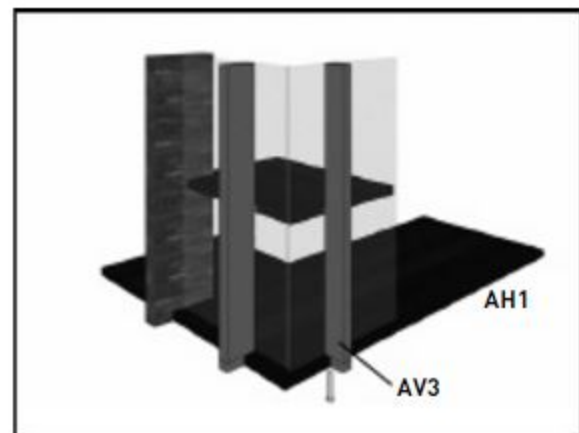

Attach AV6 to AH1 using one (1) screw.

6

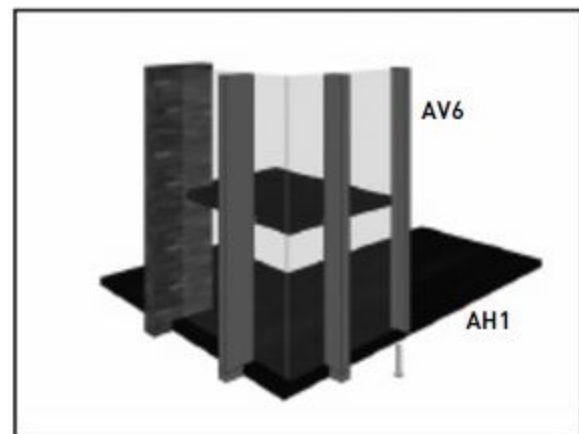

7

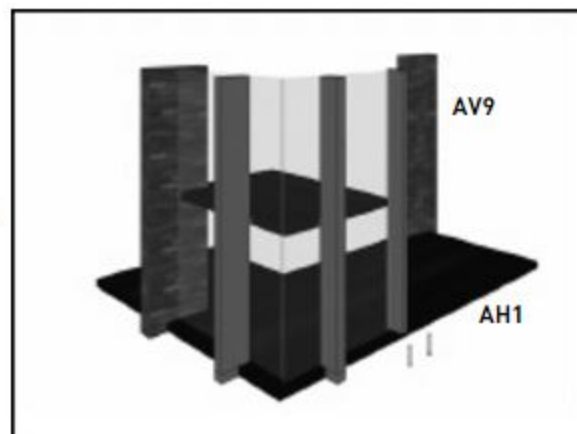

Attach AV9 to AH1 using two (2) screws.

8

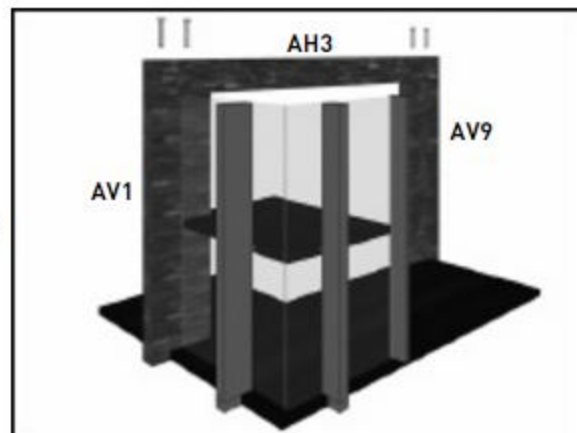

Attach AH3 to AV1 and AV9 using four (4) screws.

9

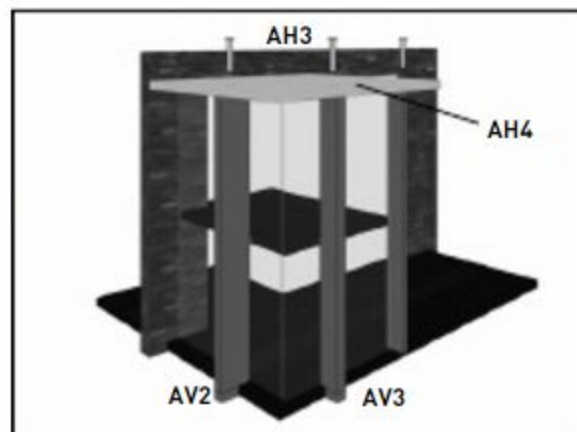

Attach AH4 to AV2, AV3 and AH3 using five (5) screws.

6

Attach AV7 and AV8 to AH1 using two (2) screws.

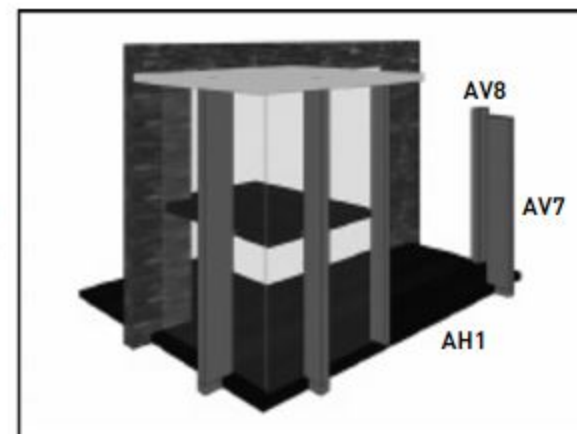

10

Place AV10, AV11 and AV12 into the slots in AH1.

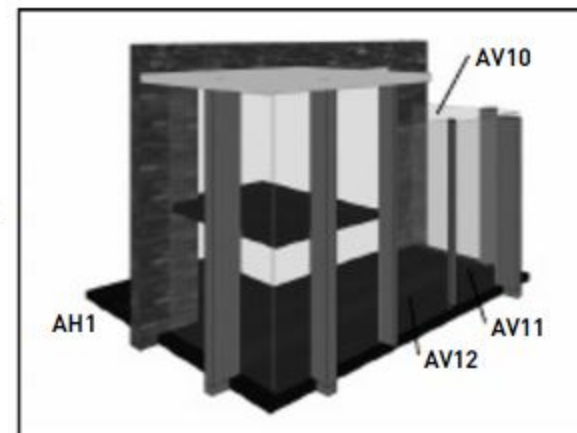

11

Attach AH5 to AV7, AV8 and AV9 using four (4) screws.

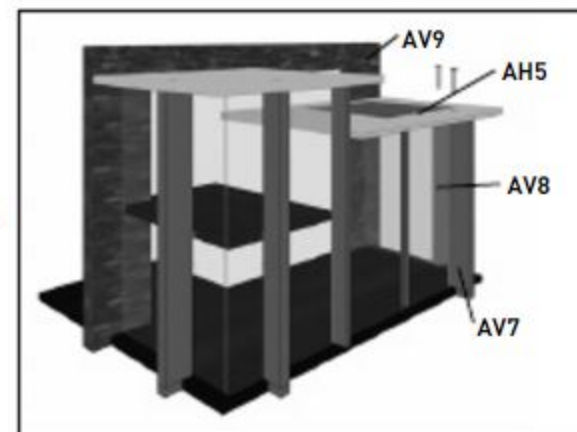

12

7

13

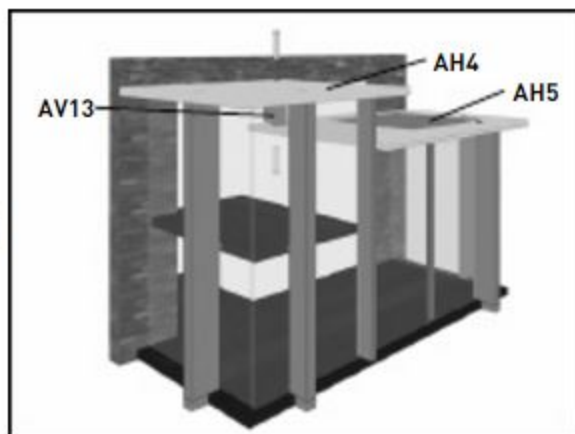

Attach AV13 to AH4 and AH5 using two (2) screws.

14

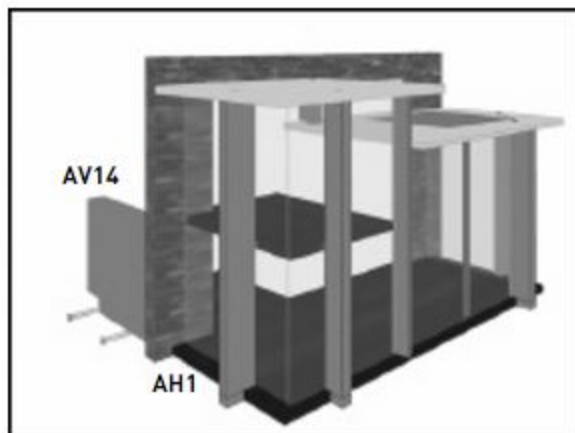

Attach AV14 to AH1 using two (2) screws.

1

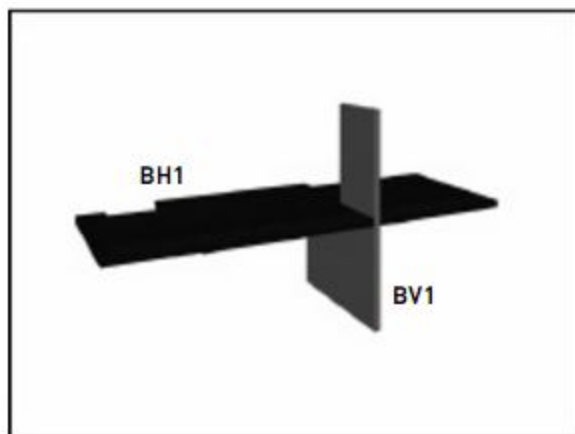

SIDE B
Attach BH1 and BV1.

8

Attach BV2 to BH1 using two (2) screws.

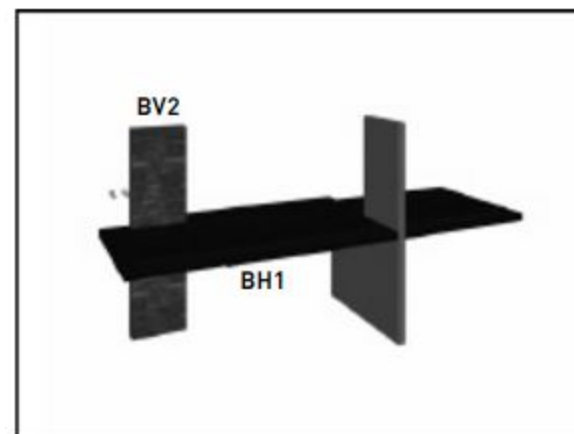

2

Place BV6 into place in between BH1 and BV2.

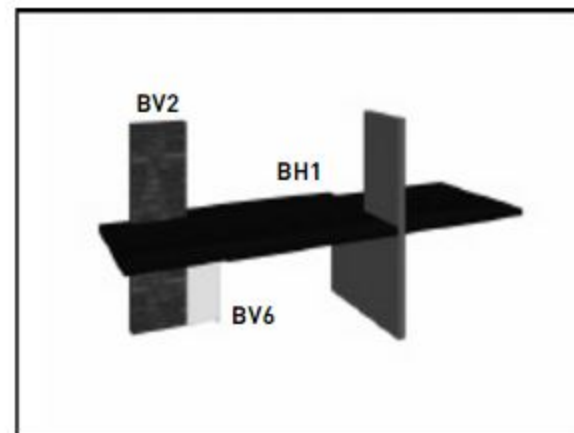

3

Attach BH2 to BV1 and BV2 using four (4) screws.

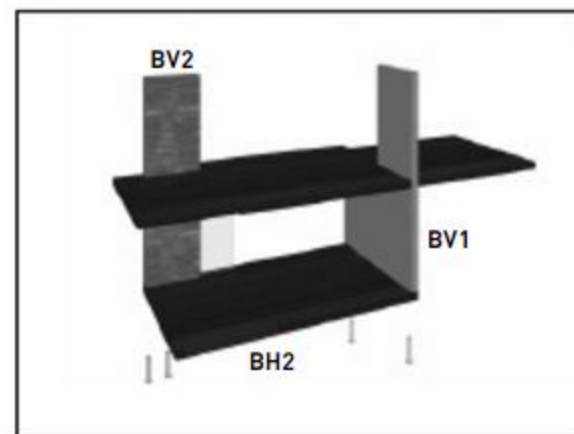

4

9

5

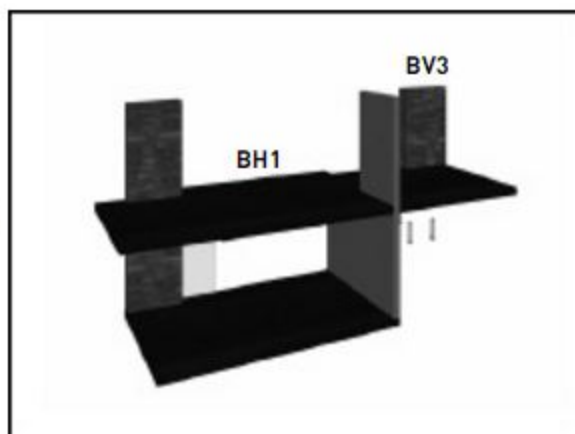

Attach BV3 to BH1 using two (2) screws.

6

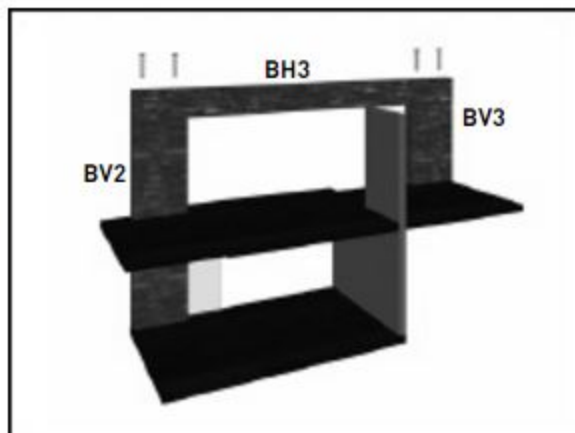

Attach BH3 to BV2 and BV3 using four (4) screws.

7

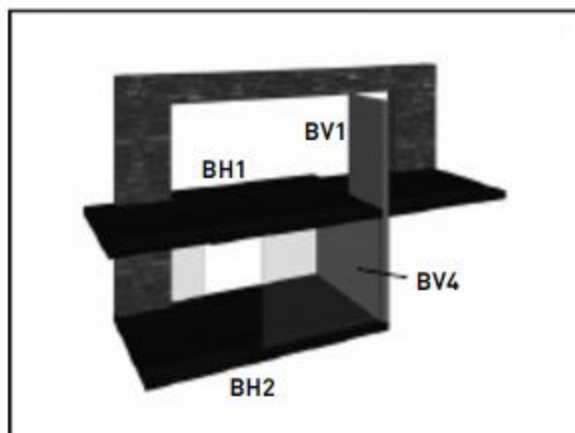

Slide BV4 into place in the grooves in BV1, BH1 and BH2.

10

Attach BV5 to BH1 and BH2 using two (2) dowels and two (2) screws.

8

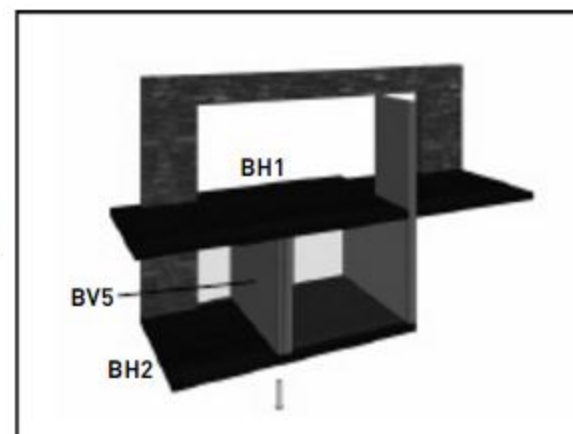

Attach BV7, BV8, BV9 and BV10 to BH1 using seven (7) screws.

9

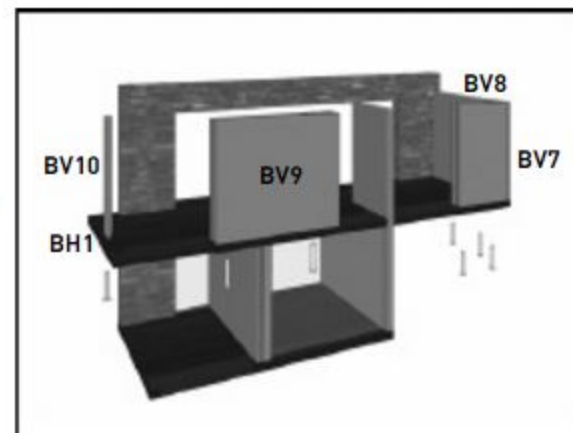

Slide windows BV11, BV12, BV13, BV14, BV15, BV16 and BV17 into place.

10

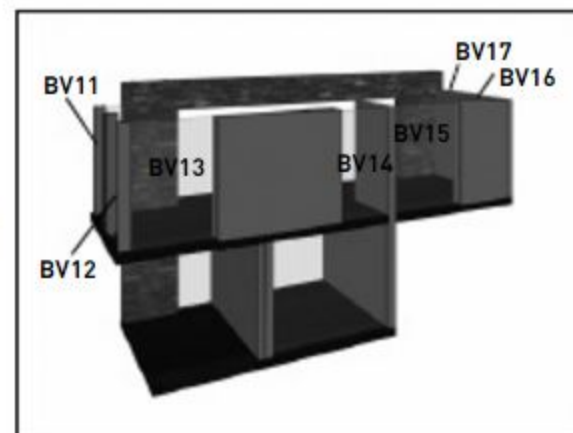

11

11

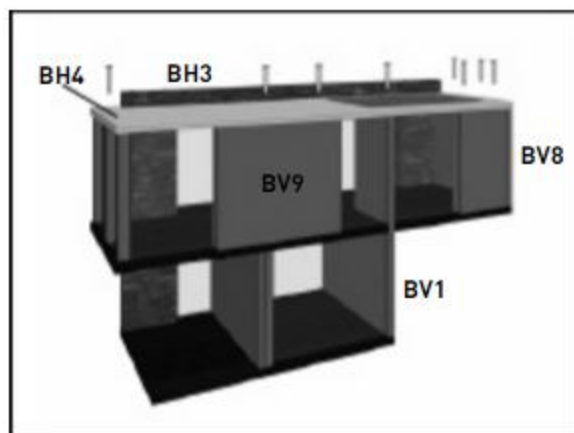

Attach BH4 to BV1, BH3, BV8, BV9 and BV10 using nine (9) screws.

1

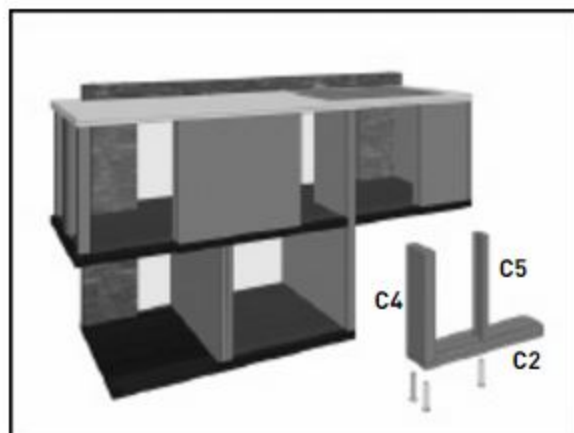

CORNER

Attach C4 and C5 to C2 using three (3) screws.

2

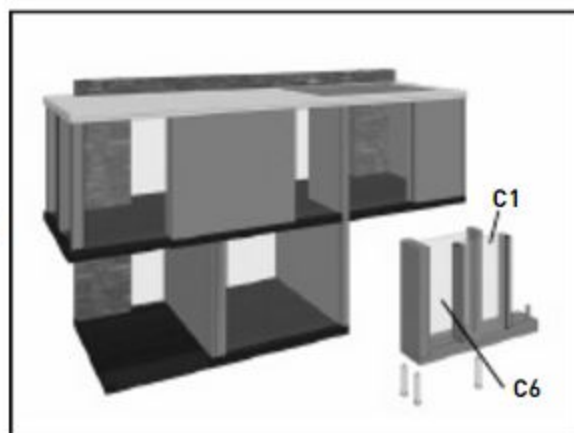

Slide windows C1 and C6 into place.

12

Attach C2 to AV14 using dowel.

3

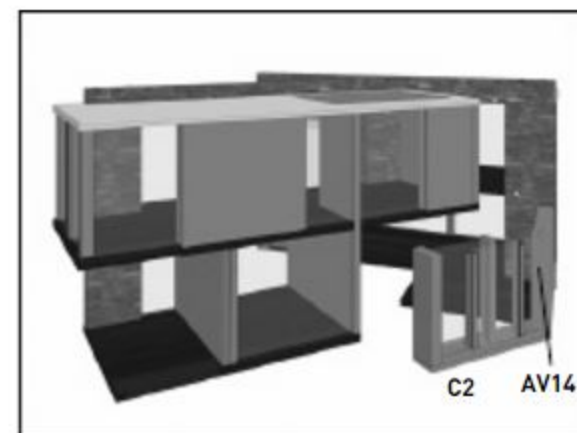

4

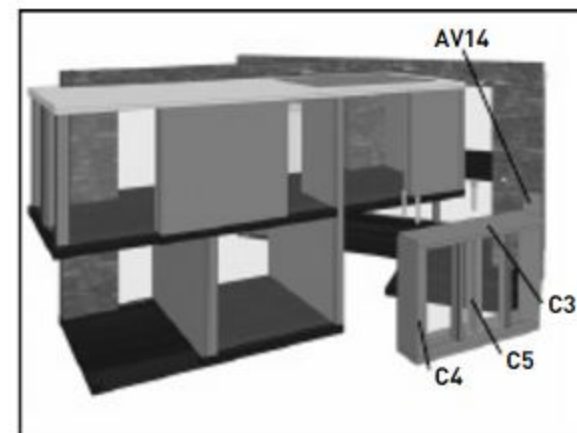

Attach C3 to AV14 using dowel. Attach C4 and C5 to C3 using three (3) screws.

CONNECT

Attach C4 to BV1 using two (2) screws.

13

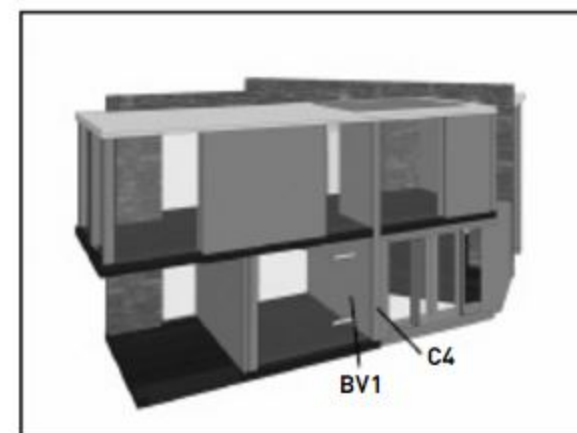

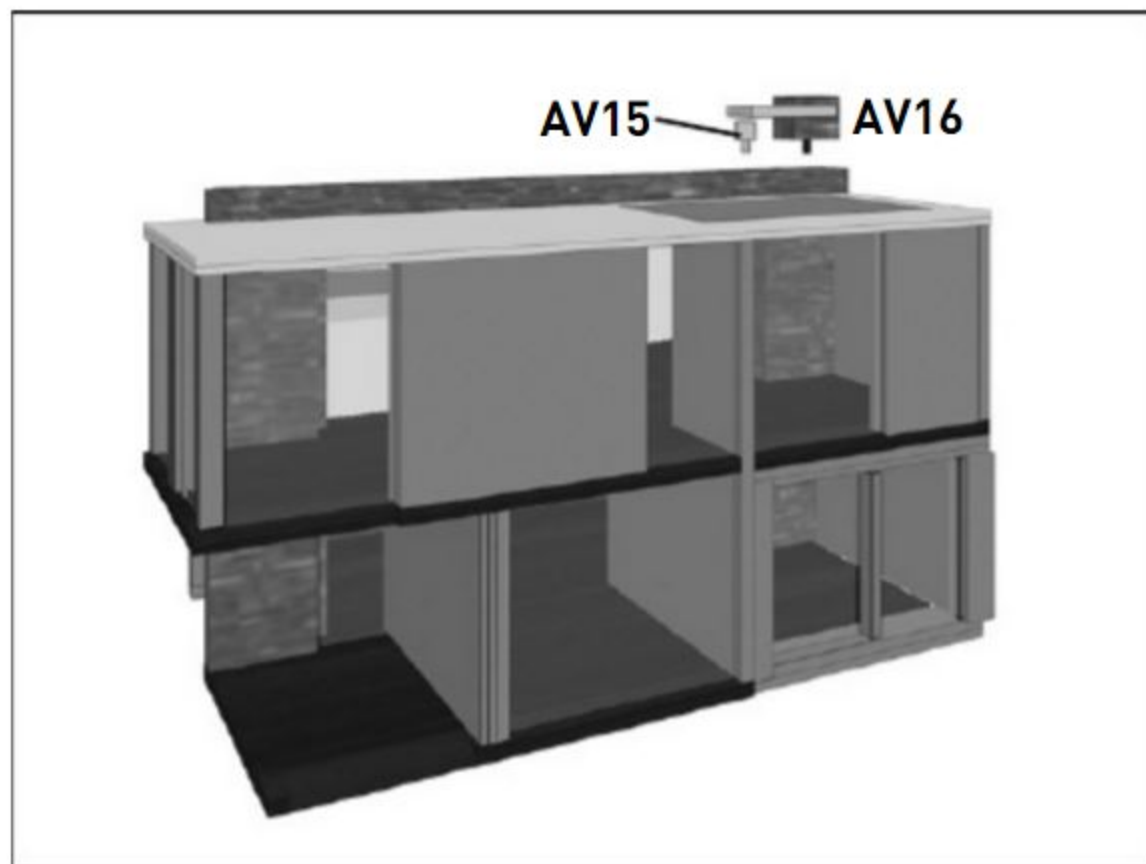

AND FINALLY...

Attach AV16 and AV15.