

Slide Card

Front Cover Removal

In order for the Slide-Card to work, you have to remove the front cover of the cd/dvd drive. This can be done without having to open the console, as it is "clipped" on from the outside!



Step1 - RemoveScrew

1. Turn on your PlayStation2 and press the eject button, so that the tray comes out.
2. Let the tray stay out, and then turn OFF the power on the back side of your PlayStation2 (rock-er switch). Now the console has no power, and the tray is still out.
3. Turn around the console, and place it on a table with good light source, so you can see what you're doing!
4. Now remove/unscrew the tiny screw on the back of the tray. You may feel it is stuck really tight, but use a good screwdriver, and it should'nt be a problem.



Step2 - RemoveCover

1. Get the smallest screwdriver you can find, or use a pin. The cover is "clipped" on in right and left side of the tray. The clips on the tray holding the cover easily break, so be very carefull. You just have to expand is about 0,5 milimeters in each side at a time, and it comes right off.
2. When you see/find the clips, put the pin or screwdriver down, and twist a little - while pulling gently in the cover. It comes of!



Hints: If you do not feel secure about it, then heat up the plastic material a little using a blowdryer so it becomes more flexible. If it should break, it's not the end of the world - a little super glue and you will never know the difference..

Step3 - Replace screw

1. Now it's time to replace the screw you removed. Simply reinstall it and your done!
2. Now your ready to use the Slide-Card!
3. The Front Cover you just removed can be reattached easily whenever you want!

Slide Card

Instructions - playing imports

This guide assumes that you have already removed the Front Cover of your PlayStation2. Now follow this instruction closely, and you will be playing your imported games in no time!

Step1 - Start SwapMagic

1. Simply turn on the PlayStation2, insert Swap Magic Bootdisc CD or DVD version, according to what type of import game you are about to play. Wait for the screen to say "Insert Disc".

Step2 - Slide Tray Open

1. Insert the Slide-Card UNDER the the tray on the LEFT side. (With the "arm" facing right). Leave a 2cm gap on the far left, and it should go in without any problems.
2. Now "Slide" your card gently to the RIGHT keeping a firm grip. You will feel a litte resistance, but keep sliding and the tray will come out a little automaticly.
3. Now it is ready to be pulled fully out.



Step3 - SwapDiscs & Close

1. Now remove the Swap Magic Boot Disc and insert your import disc.
2. Now push the tray all the way back in! Do this on the left side of the tray to make it slide easier.



Step4 - Slide Back

1. Now it is time to make the final Slide! Insert the Slide-Card to the left as you did in Step 2.1.
2. Now gently Slide the Slide-Card to the RIGHT again, but this time - when the tray comes out a little automaticly - then release the preasure on the Slide-Card and continue to Slide the Card to the right (it moves around a little bumb and grabs like a hook!).
3. Now make sure the Slide-Card has hooked the tap and is well inserted!
4. Now Slide the Card gently all the way to the LEFT - the tray will close completely. Take out the Slide-Card!
5. Press X on joypad - and you are playing your imports.

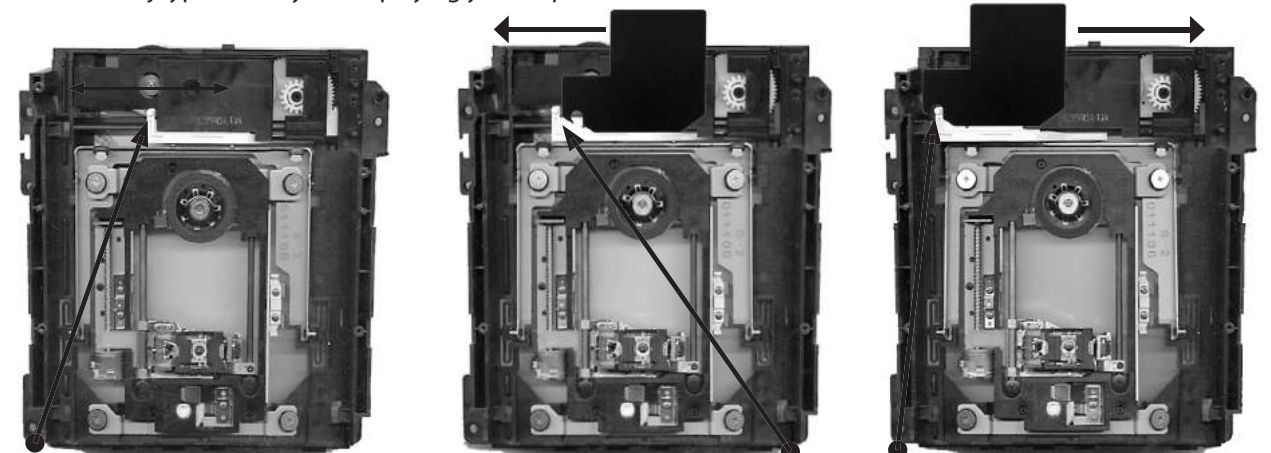

INFO: This little tap inside the drive has to be pushed left (Step 2) by the end of the Slide-Card. Next pulled back (Step 4) using the hook on Slide-Card!

STEP 2: The Slide-Card should be inserted under the drive always with the "arm" facing to the right! Push the tap all the way to the right and pull out drive!

STEP 4: Now the hook has to be used to "grap" the tap - and then pull it back! EASY!