

SKYHAWK INSTRUCTIONS

YUNNAN PROVINCE

THE DOUGLAS A4D-1 SKYHAWK

The A4D Skyhawk fighter-bomber, which entered service with the U.S. Navy in October, 1956, is claimed to be the smallest and lightest American combat jet.

Designed and built within eighteen months, the tiny Skyhawk combines a speed comparable with many fighters and the ability to carry an atomic bomb. It is designed to operate from any size of aircraft carrier, or from short landing fields. Because of the small size the Skyhawk does not require the folding wings necessary for most carrier-based aircraft, and simplified design makes it easier to produce and maintain than the normal complicated modern jet aircraft.

The Skyhawk is powered by a Wright J65 turbojet, giving a speed of approximately 700 m.p.h. Armament consists of two 20 mm. cannon, and underwing load can include bombs, rockets or guided missiles. Wing span: 27 ft. 6 in. Length: 39 ft. 5 in.

SKYHAWK INSTRUCTIONS

1 FUSELAGE ASSEMBLY

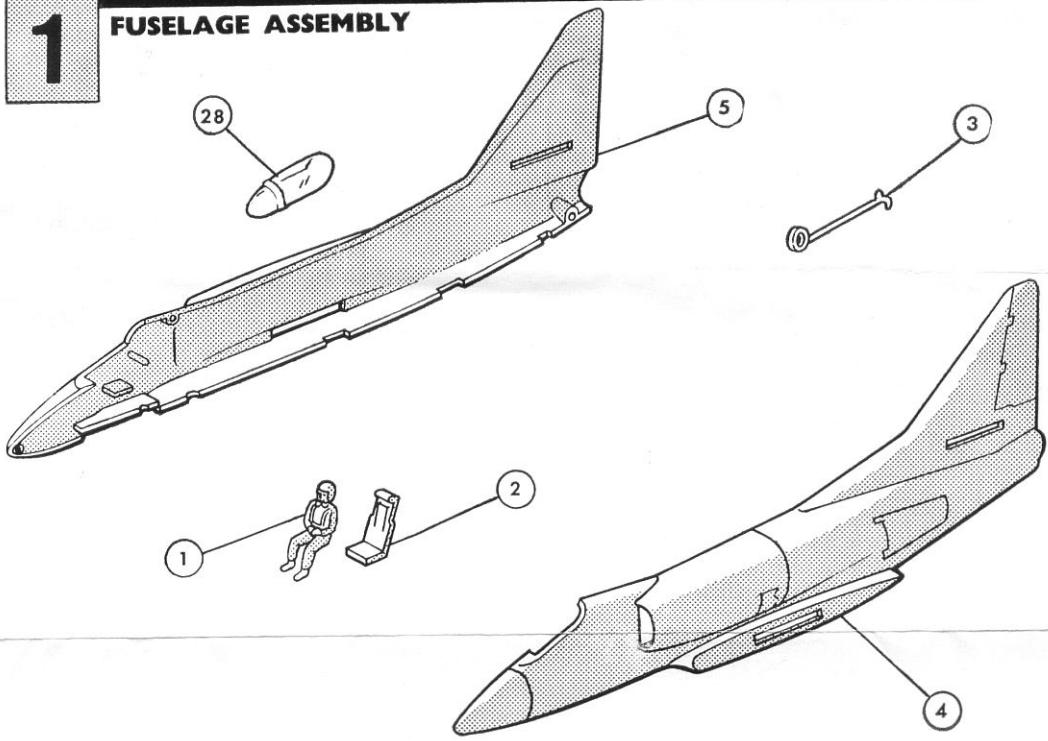

It is recommended that the instructions and exploded view are studied before assembly. If it is wished to paint internal details such as pilot and cockpit interior this should be done before assembly.

1. Cement pilot (1) on to ejector seat (2) after first painting if required.
2. Locate and cement seat into locations provided in one fuselage half.

3. Position arrestor hook (3) on locating pivot in port fuselage half. (4)
4. Cement together port and starboard (5) sides of fuselage, ensuring no cement comes into contact with arrestor hook.
5. Cement canopy (28) into position, applying cement carefully to edges of canopy.

2 WING ASSEMBLY

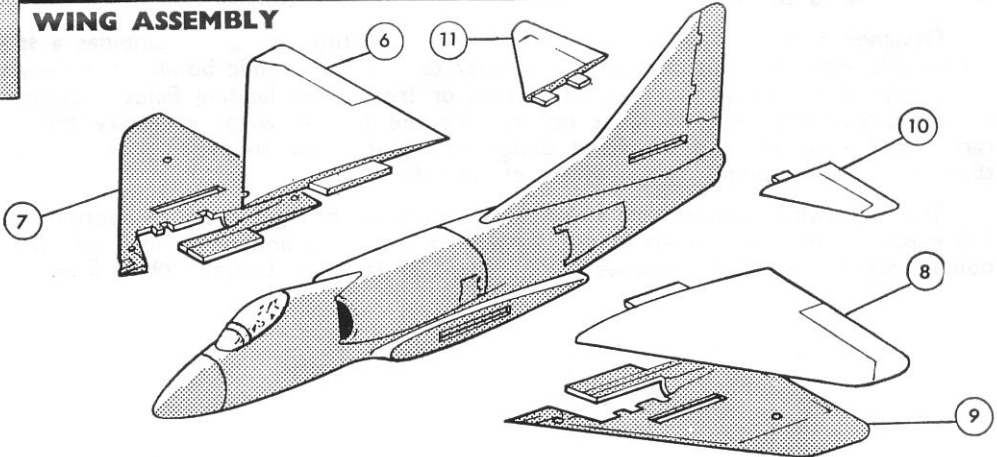

6. Cement together upper and lower halves of port and starboard wings (6, 7, 8 and 9).
7. When wings are dry cement into locating holes in

8. Cement tabs on port and starboard tailplanes (10, 11) into slots in tailfin.

fuselage sides, by means of tabs on wings.

3 UNDERCARRIAGE ASSEMBLY

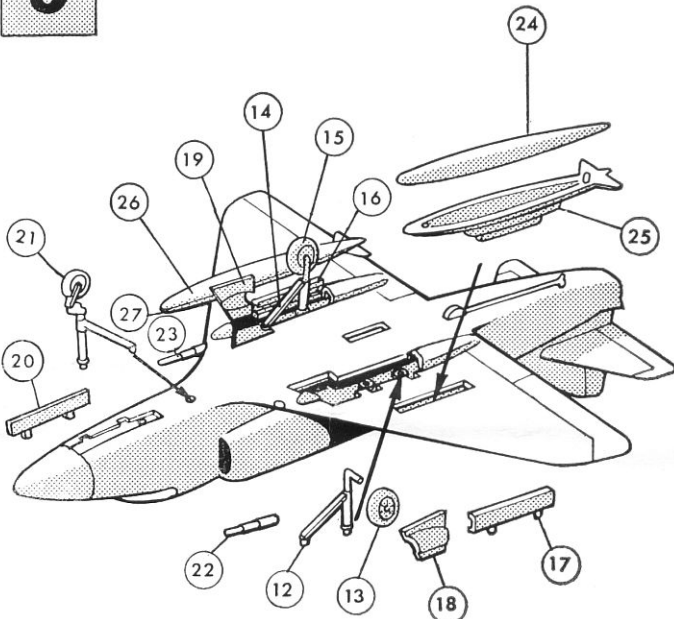

THE DESIRED UNDERCARRIAGE POSITION SHOULD NOW BE CHOSEN.

9. For a model with lowered undercarriage. Cement wheels on to axles of undercarriage legs (12, 13, 14 and 15).
10. Locate and cement main undercarriage doors (16, 17) to wings, outboard of wheel wells.
11. Similarly locate and cement forward main undercarriage doors (18 and 19)
12. Cement undercarriage legs into wing locations.
13. Locate nose wheel door in position beneath nose and cement (20).
14. Cement nose wheel (21) into locating hole.
15. Cement cannons (22, 23) into locating holes in wing roots.
16. Carefully cement together upper and lower halves of fuel tanks, (24—27) when dry cement locating slots beneath wings.

For a model with retracted undercarriage the wheels and undercarriage legs are omitted and the undercarriage doors cemented in place flush with the under-surface of the wing.

NOTE:—If it is wished to paint the model it should be done at this stage.

CARE MUST BE TAKEN TO ENSURE THAT GLUE IS KEPT AWAY FROM THE EYES.

X

4874

X

4874

NAVY
XB-29

NAVY
XB-29



164874
164874

516 X

516 516



DOUGLAS A4D-1
SKYHAWK

